



# Chef Tables - Stainless Steel Top with 4" Coved Riser

## Stainless Steel Cabinet Base Tables with Hinged Doors & Lock

### Certifications:



### Features:

- 1 5/8" x 6" Straight S/S Leg
- 4" Coved Riser
- Hinged Doors with or without Lock
- 96" Units have a Center Mullion with Two Sets of 48" Doors
- Legs Adjust 1" in Height
- Extra Supporting "C" Channels
- Casters Available



### Material:

- Hard Maple Bakers Top
- T-304 18 ga. Stainless Steel Body
- Stainless Steel Legs & Feet

### Options:

- Adjustable Shelf



### Single Sided:

Length	Hinged Door		Hinged Door + Lock	
	24" Width	30" Width	24" Width	30" Width
18"	CMBT-2418H	CMBT-3018H	CMBT-2418HL	CMBT-3018HL
24"	CMBT-2424H	-	CMBT-2424HL	-
30"	-	CMBT-3030H	-	CMBT-3030HL
36"	CMBT-2436H	CMBT-3036H	CMBT-2436HL	CMBT-3036HL
48"	CMBT-2448H	CMBT-3048H	CMBT-2448HL	CMBT-3048HL
60"	CMBT-2460H	CMBT-3060H	CMBT-2460HL	CMBT-3060HL
72"	CMBT-2472H	CMBT-3072H	CMBT-2472HL	CMBT-3072HL
96"	-	CMBT-3096H*	-	CMBT-3096HL*

### Dual-Access:

Length	Hinged Door		Hinged Door + Lock	
	24" Width	30" Width	24" Width	30" Width
18"	CMBT-2418H2	CMBT-3018H2	CMBT-2418HL2	CMBT-3018HL2
24"	CMBT-2424H2	-	CMBT-2424HL2	-
30"	-	CMBT-3030H2	-	CMBT-3030HL2
36"	CMBT-2436H2	CMBT-3036H2	CMBT-2436HL2	CMBT-3036HL2
48"	CMBT-2448H2	CMBT-3048H2	CMBT-2448HL2	CMBT-3048HL2
60"	CMBT-2460H2	CMBT-3060H2	CMBT-2460HL2	CMBT-3060HL2
72"	CMBT-2472H2	CMBT-3072H2	CMBT-2472HL2	CMBT-3072HL2
96"	-	CMBT-3096H2*	-	CMBT-3096HL2*

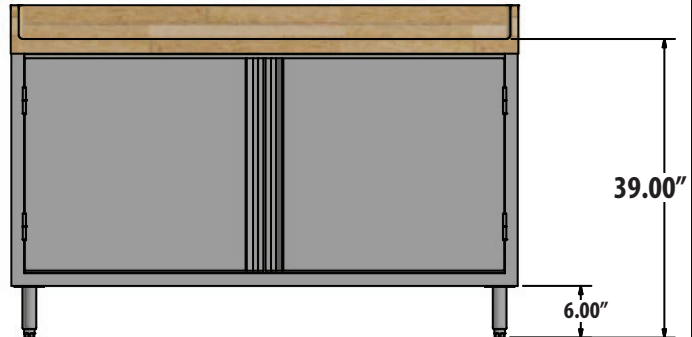
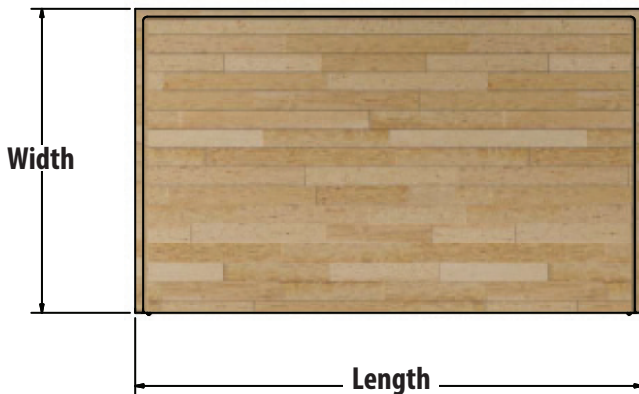

PRODUCT DATA SHEET

BK RESOURCES

