



# Underbar Drain Boards

## Stainless Steel Underbar Drain Boards



Use your smart phone to scan the above QR code to visit our website:  
www.bk-resources.com

### Certifications:



### Features:

- Standard 18" or 21" Depth
- Stamped & Pitched Drainboards
- Includes: BKDR-15CP Drain
- 18GA SS Front Panels w/ Galv Die Wall & Base
- Removable SS Front Panel on Base



### Material:

- T-304 18 ga. Stainless Steel
- 18 Ga SS Front Panels w/ Galv Die Wall & Base

Part Number	Unit Size (l x w x h)
UBDW-18-DB12	12" x 23 1/2" x 41"
UBDW-18-DB18	18" x 23 1/2" x 41"
UBDW-18-DB24	24" x 23 1/2" x 41"
UBDW-18-DB30	30" x 23 1/2" x 41"
UBDW-18-DB36	36" x 23 1/2" x 41"
UBDW-18-DB48	48" x 23 1/2" x 41"
UBDW-21-DB12	12" x 26 3/4" x 41"
UBDW-21-DB18	18" x 26 3/4" x 41"
UBDW-21-DB24	24" x 26 3/4" x 41"
UBDW-21-DB30	30" x 26 3/4" x 41"
UBDW-21-DB36	36" x 26 3/4" x 41"
UBDW-21-DB48	48" x 26 3/4" x 41"

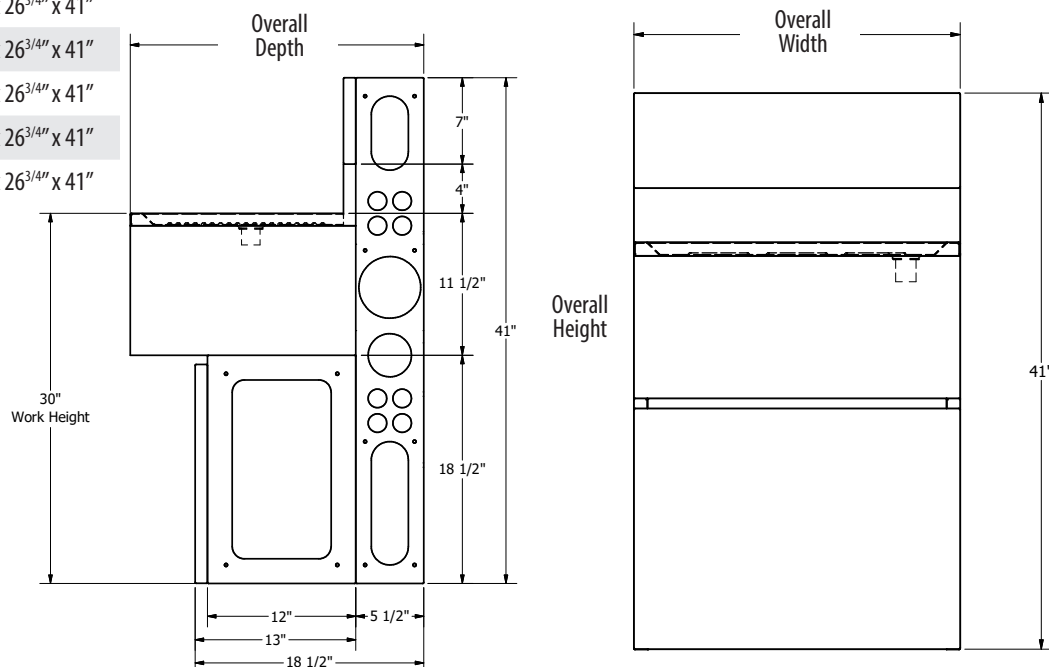
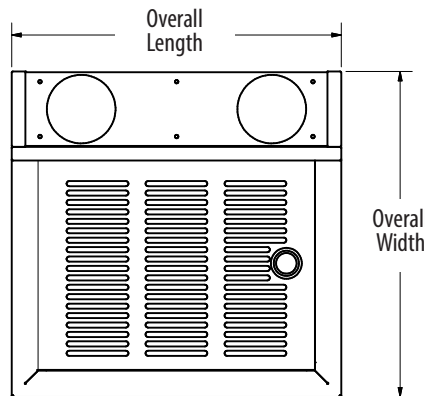

PRODUCT DATA SHEET

BK RESOURCES

