



# Chef Tables - Stainless Steel Top with 5" Riser

## Stainless Steel Cabinet Base Tables with Sliding Doors

### Certifications:



### Features:

- 1 5/8" x 6" Straight S/S Leg
- Sliding Doors
- 5" Riser
- 96" Units have a Center Mullion with Two Sets of 48" Doors
- Legs Adjust 1" in Height
- Casters Available



### Material:

- T-304 14 ga. Stainless Steel Top
- T-304 18 ga. Stainless Steel Body
- Stainless Steel Legs & Feet

### Options:

- Adjustable Shelf



Length	24" Width	30" Width
36"	CSTR5-2436S	CSTR5-3036S
48"	CSTR5-2448S	CSTR5-3048S
60"	CSTR5-2460S	CSTR5-3060S
72"	CSTR5-2472S	CSTR5-3072S
96"	-	CSTR5-3096S

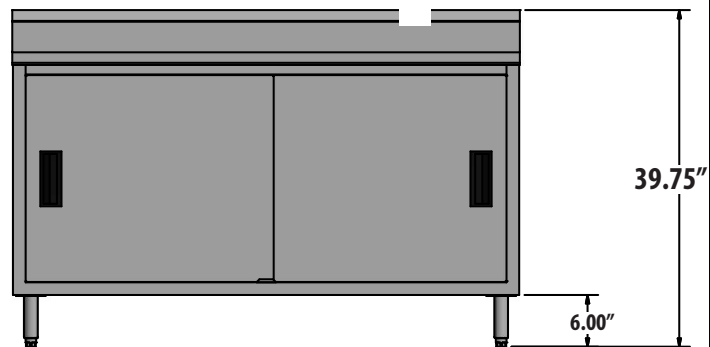
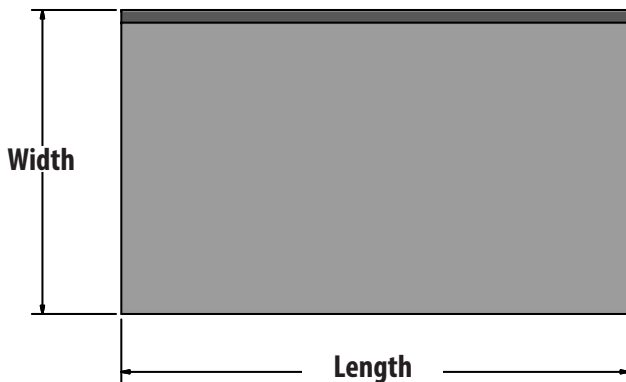

PRODUCT DATA SHEET

BK RESOURCES

